

Gateway

Model No.: PTG10



Overview 1.

The gateway PTG10, providing internet access for whole smart home system, is directly plugged into socket which better nearby home wireless broadband router, no need a spare Ethernet port on the user's home broadband router.

1. System requirement

- 802.11 b/g home wireless router.
- Effective broadband connections.
- 90-260AC power supply.
- android or IOS smartphone, PC or Pad.

2. System Application

Overview 2.

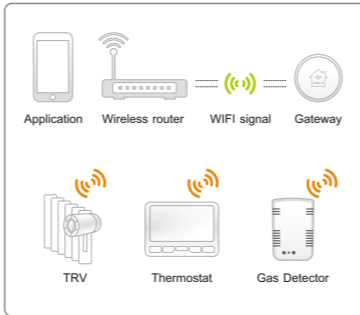

Using Introduction 3.

1 Download App. by searching Poersmart from Apple Store or Google Play; or scanning QR code with smart phone(Android).



Using Introduction 4.

2 Register your account and set basic information about your home.

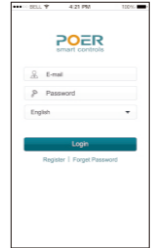

www.poersmart.com

Using Introduction 5.

3 Gateway installation
Plug in the gateway, the LED on gateway will blink rapidly before registered on wireless router.

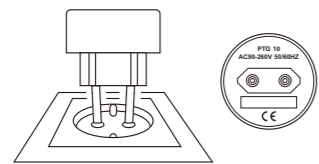

Using Introduction 6.

Note Once gateway was plugged in socket, the LED on gateway will blink rapidly when it is not connected with the network. Now register the gateway on Wi-Fi router or inspect Wi-Fi connection if already registered the gateway.



Using Introduction 7.

4 Gateway Registration
Register gateway on wireless router by enter password.

- 1 Choose Add Gateway.
- 2 Make gateway under Pairing Mode by long pressing the touch button.
- 3 Enter Wi-Fi's password.
- 4 Checking Wi-Fi connection between phone and router, gateway and server before add controlling devices on App. Once all is ready, go to add controlling devices.

Using Introduction 8.

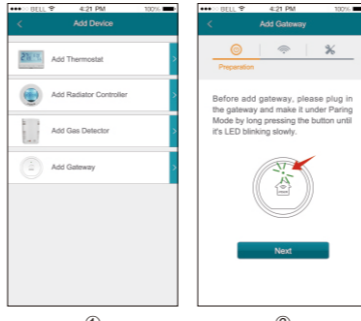

Using Introduction 9.

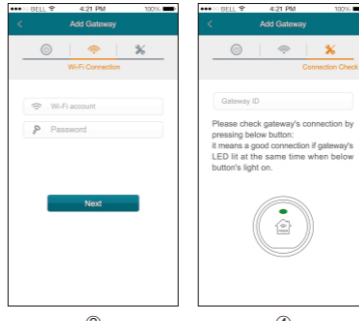

Using Introduction 10.

5 Gateway LED goes off to show it is connected to the network and ready to pair with the controlling devices.

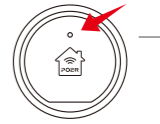

6 RF single pairing between Gateway and devices
Please refer to devices' manual for gateway's pairing with individual controlling devices.

尺寸 : 336 X 56mm
印色 : CMYK
材质 : 80g双胶纸
其他 : 五折页, 风琴折, 正反印